



# TYP R, RU/RB, RUB/RX

Standardspannmutter nach DIN 6499 / ISO 15488  
Standard clamping nut according to DIN 6499 / ISO 15488



R, RU



RUB, RX

Standard	Beschichtet / Coated		Dimensionen / Dimensions		
	Typ Type	Art. Nr. Item no.	M	D	L
R11	2.110.11	1	M14x0.75	19.0	12.0
R12	2.110.12	1	M14x0.75	19.0	12.0
R11	2.110.16	1	M2x1.50	28.0	18.0
R12	2.110.20	1	M2.5x1.50	34.0	19.5
RU16	2.120.16	1	M2x1.50	32.0	18.0
RU20	2.120.20	1	M2.5x1.50	35.0	19.5
RU25	2.120.25	1	M3.2x1.50	42.0	20.5
RU32	2.120.32	1	M4.0x1.50	50.0	23.0
RU40	2.120.40	1	M5.0x1.50	63.0	26.0
RU50	2.120.50	1	M6.6x2.00	78.0	35.0
RX16	2.410.16	1	M2x1.50	32.0	18.0
RX20	2.410.20	1	M2.5x1.50	35.0	19.5
RX25	2.410.25	1	M3.2x1.50	42.0	20.5
RX32	2.410.32	1	M4.0x1.50	50.0	23.0
RX40	2.410.40	1	M5.0x1.50	63.0	26.0
RX50	2.410.50	1	M6.6x2.00	78.0	35.0

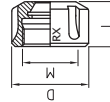
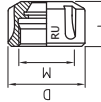
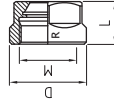

Zangen Collets	Spannbereich Clampinh range	Härte Hardness	Max. Anzugsmoment Max. torque	Max. Drehzahl*1) Max. revolutions*1)	Rundlauf Rotation	Schlüssel Wrench	Dichtscheibe Sealing disk
			40	40'000	0.002	9.100.11	-
			40	40'000	0.002	9.100.11	-
			80	40'000	0.002	9.100.16	-
			110	40'000	0.002	9.100.20	-
			80	40'000	0.002	9.130.16	-
			110	40'000	0.002	9.130.20	-
			140	35'000	0.002	9.130.25	-
			180	35'000	0.002	9.130.32	-
			240	25'000	0.003	9.130.40	-
			330	15'000	0.004	9.130.50	-
			80	40'000	0.002	9.130.16	-
			110	40'000	0.002	9.130.20	-
			140	35'000	0.002	9.130.25	-
			180	35'000	0.002	9.130.32	-
			240	25'000	0.003	9.130.40	-
			330	15'000	0.004	9.130.50	-

\*1) Bitte beachten Sie die Restunwucht des gesamten Werkzeugsystems  
\*2) Please attend to the rest unbalance of the assembled tool system